

NOTES:

- ① J-BOXES: J1--NORMAL POWER. LINE VOLTAGE TO BE 1/2" EMT CONDUIT. 3/4" EMT CONDUIT STUB-UPS PROVIDED FOR LOW VOLTAGE CONNECTIONS (BY OTHERS).
- ② DEVICE MOUNTING PANELS: 3D LAMINATE SELECTION TO BE DETERMINED. WOOD GRAIN TO BE IN A VERTICAL ORIENTATION.
- ③ PATIENT INFORMATION MARKERGLASS BY SKYLINE PRICED SEPARATELY.
- ④ DECORATIVE KNOBS TO BE CLEAR ANODIZED ALUMINUM AND DEVICE COVER PLATES TO BE STAINLESS STEEL.
- ⑤ FORM® UNIT IS SURFACE MOUNTED IN VERTICAL SECTIONS (BY OTHERS).
- ⑥ INSET SURFACE PROVIDED FOR BASE MATERIAL (BY OTHERS).
- ⑦ ACTUAL OUTER PANEL WIDTHS WILL BE THE MODULE + 1 1/2".
- ⑧ BLOCKING REQUIRED IN THIS AREA.
- ⑨ ITEMS SHOWN FOR PRESENTATION PURPOSES ONLY. SUPPLIED BY OTHERS.

MODULAR 500 EAST BRITTON ROAD
SERVICES COMPANY OKLAHOMA CITY, OK 73114

REVISED

FORM® BENCHWALL
7500 SERIES
FLOOR MOUNTED SYSTEM

SCALE:  =1'

DATE _____ DRAWN BY _____ DRAWING # _____

PROJECT _____

NOT FOR CONSTRUCTION
CONCEPTUAL ONLY

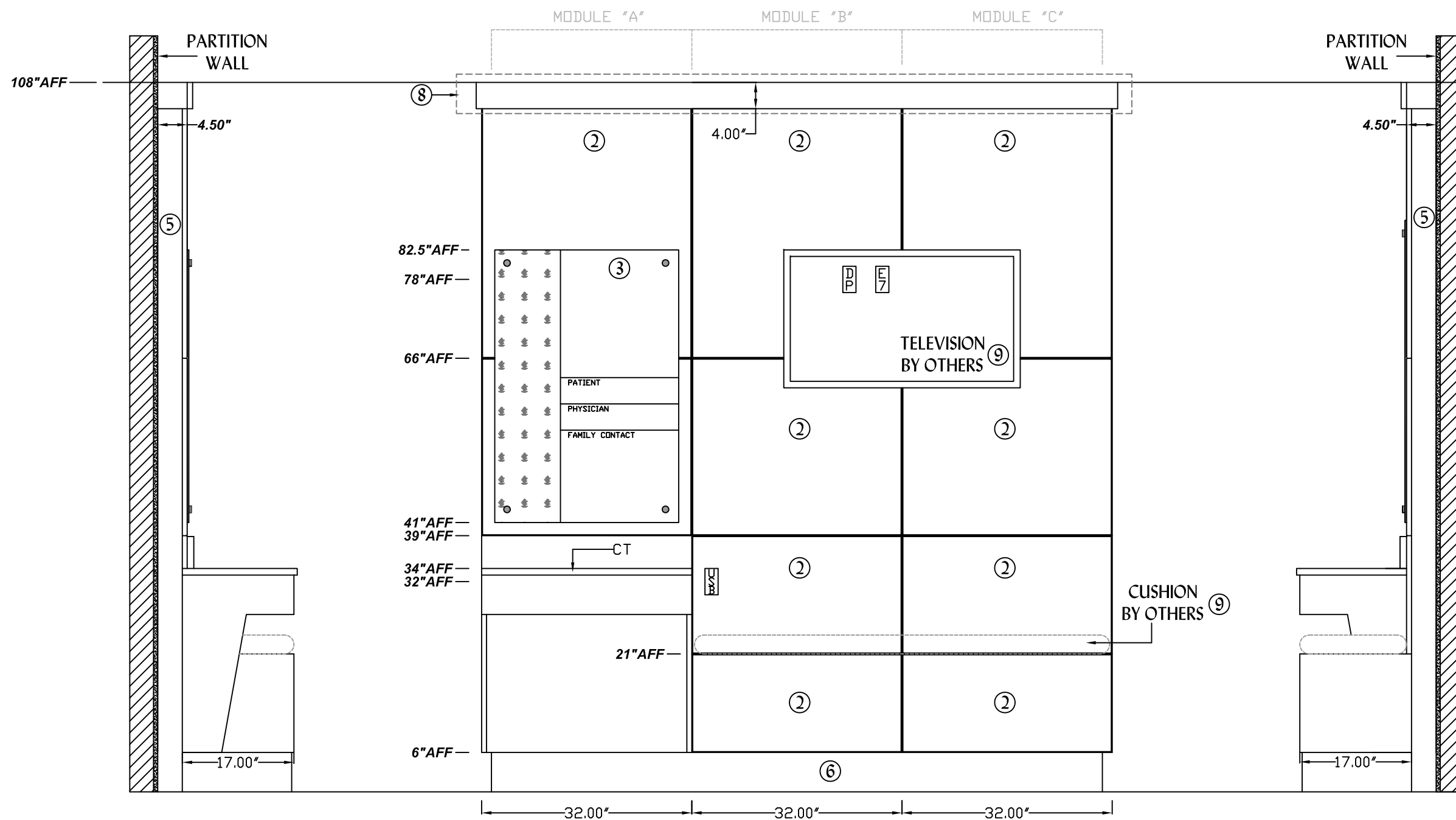

LEGEND

REQ	SYM	DESCRIPTION
1	E7	DUPLEX RECEPTACLE, 8300 WHITE, 20A, 125V, H.G., NORMAL POWER
1	USB	USB CHARGER RECEPTACLE, HUBBELL, 20A, 125V AC, WHITE, USB8300W
1	DP	DATA OUTLET PROVISION SINGLE GANG OPENING W/BLANK FACEPLATE
1	CT	SOLID SURFACE COUNTER

REQ ACCESSORIES NOT SHOWN (PER UNIT)